

RTH, RB series

**Wheels for stackers,
drive and running wheels
for forklift trucks**

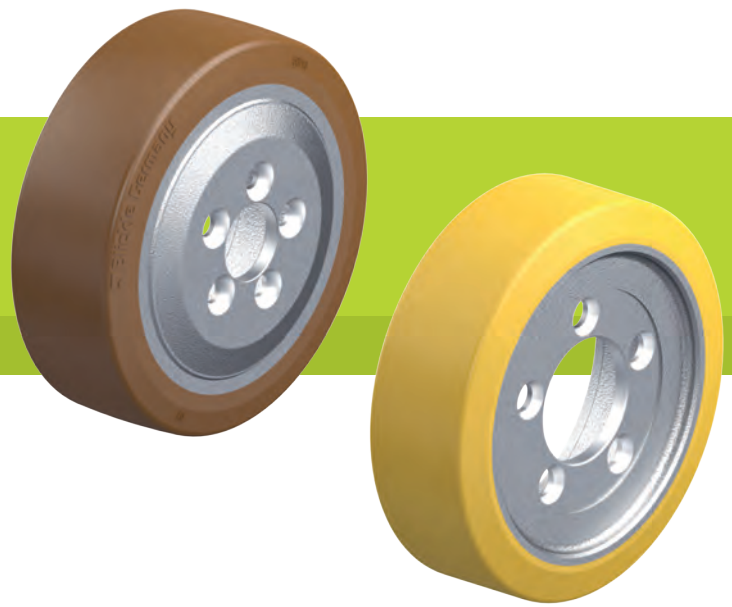

Wheel: RTH series

- tread: high-quality polyurethane elastomer Blickle Extrathane®, hardness 92 Shore A, low rolling resistance, high abrasion resistance, high cut and tear propagation resistance, colour light brown, non-marking, non-staining, excellent chemical connection with the wheel centre (see page 55 for a material description)
- wheel centre: rugged grey cast iron or ductile cast iron
- overview wheel series page 79

Wheel: RB series

- tread: high-quality polyurethane elastomer Blickle Besthane®, hardness 92 Shore A, very low rolling resistance, **high dynamic load capacity**, high abrasion resistance, high cut and tear propagation resistance, colour brown, non-marking, non-staining, excellent chemical connection with the wheel centre (see page 56 for a material description)
- wheel centre: rugged grey cast iron or ductile cast iron
- overview wheel series page 80



Still



Stöcklin



Wagner



Wagner



Wagner

Suitable for manufacturer no. 359920	Suitable for manufacturer no. 360503	Suitable for manufacturer no. 334295	Suitable for manufacturer no. 359920	Suitable for manufacturer no. 305061
Product code RTH 230x75/45-5	Product code RTH 255x83/80-5	Product code RB 300x100/80-5	Product code RTH 230x75/45-5	Product code RTH 255x83/80-5

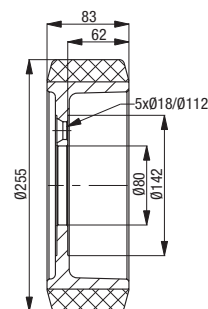
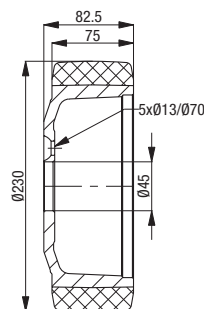
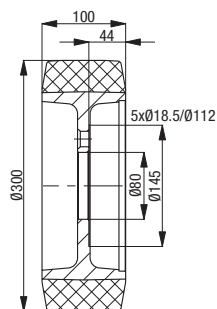
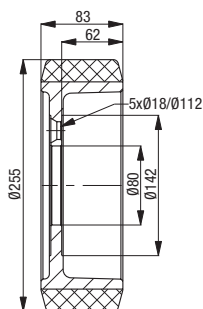
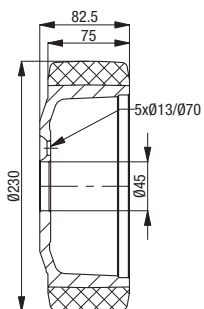

Other dimensions available upon request